

ENGLISH

INSTRUCTION MANUAL

16A Wi-Fi Switch Module

AS-MM1/QS-WIFI-S06-16A

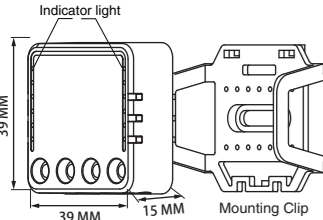

Hereby, Life365 Italy S.p.A., declares that this wireless device complies with the essential requirements and other related provisions of Directive 2014/53/EU of the European Parliament and of the Council. The declaration can be consulted on the website www.homcloud.com/doc.

"Homcloud" is a registered trademark of Life365 Italy S.p.A.

TECHNICAL SPECIFICATIONS

Product type	Mini Wi-Fi Switch Module
Voltage	100-250V AC
Current	16A
Max. load	3680W/300W for LED
WiFi frequency	2.4GHz-2.4835GHz WiFi 802.11 b/g/n
Operation temp.	-10°C - +40°C
Case temp.	Tc: +80°C (Max.)
Operation range	≤ 200 m
Dims (WxDxH)	39X39X15 mm
IP rating	IP20
Warranty	2 years
Certificates	CE, ROHS
Max transm. power:	19,91dBm (Max Antennagain 3dBi)
EMC Standard (EMC)	EN 300 328 V2.1.1 (2016-11), EN 301489-1 V2.1.1 (2017-02), EN 301489-17 V3.1.1 (2017-02), EN 62311: 2008, EN 61000-6-1:2007, EN 61000-6-3:2007+A1:2011
Safety Standard (LVD)	IEC 60669-2-1:2002/AMD1:2008/AMD2:2015, IEC 60669-1:1998/AMD1:1999/AMD2:2006, EN 60669-2-1:2004+A1: 2009+ A2:2010, EN 60669-1:2018
RoHS Standard (RoHS)	2011/65/EU, (EU) 2015/863
Radio Equipment (RED)	ETSI EN 300 328 V2.1.1 (2016-11)

MAIN FEATURES

The Wi-Fi 16A switch module is designed to transform your traditional wall switches into a Wi-Fi switches that allows the connected device to be controlled via smartphone as well as traditional switches on wall.

Notes:

- Both the adjustment on App and switch on wall can over write each other, the last adjustment remains in memory.
- The App control is synchronized with the manual switch.
- For both single way and two way switches. **Neutral wire required - Metal faceplate not supported.**

Important

Our App only support 2.4 GHz Wi-Fi networks, IEEE 802.11 b/g/n (for configuration both device and mobile phone need to be connected at the same Wi-Fi network).

INSTALLATION

▲ Warnings:

- Installation must be carried out by a qualified electrician in accordance with local regulations.
- Keep the device out of reach of children.

- Keep the device away from water, damp or hot environment
- Install the device away from strong signal sources such as mic rowave oven that may cause signal interruption resulted to abnormal operation of the device.
- Obstruction by concrete wall or metallic materials may reduce the effective operation range of the device and should be avoided.
- Do NOT attempt to disassemble, repair or modify the device.

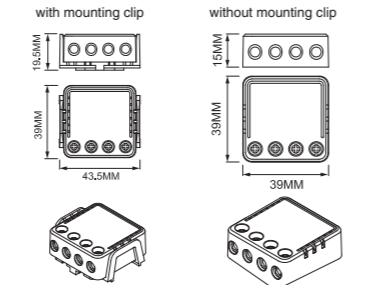

WIRING DIAGRAMS

- Turn off the power supply before carrying out any electrical installation work.
- Connect wires according to the wiring diagram.
- Insert the module into the junction box.
- Connect the power supply and follow Switch module configuration instructions.

A - Electrical scheme with 1 switch

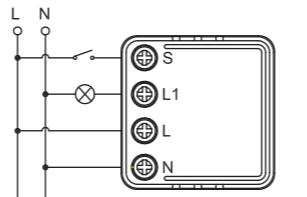

B - Electrical scheme without switches

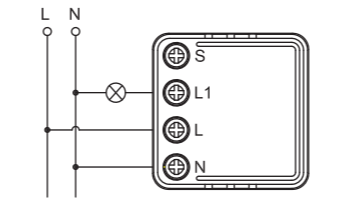

- This module can be used to control also light or electrical devices where you do not have switches on wall. You can always turn off/on light with main power supply or electrical devices with integrated switches as usual.

C - Electrical scheme with 2 switches or more

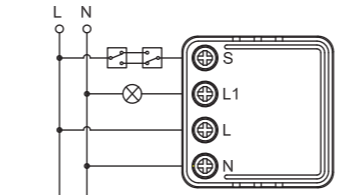

D - Electrical scheme with socket

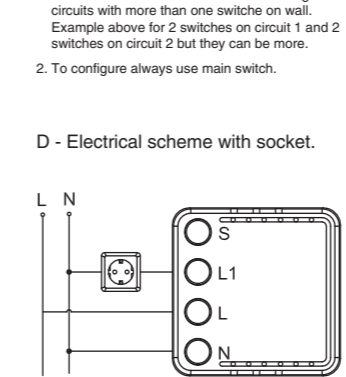

- To configure always use main switch.

DONWLOAD AND REGISTRATION

(if you have gotalreadyHomCloud App on your mobile and an Account go to Configuration).

- Download HomCloud App from App Store or Google Play or scan QR code below.



- Enter the register/login interface and register with your country area code and phone number/email address
- Wait a few minutes for verification code (by email or text message) and enter it where required along with a password. (between 6 and 20 numbers and letters)

CONFIGURATION

- Connect your mobile device to a 2.4 GHz Wi-Fi Network and launch HomCloud App.
- See "Wiring instructions" if you haven't done it yet.
- Press the traditional switches (connected to the Wi-Fi 16A switch module) ON-OFF-ON-OFF for at least 5 times (one time per second) or until the indicator light on the module flash quickly (If you wait more than 120 sec you need to repeat this passage).

- Keep smartphone close to the switch you want to configure (approx 30cm) and tap on the HomCloud homepage "add device" or the icon "+". After that tap "Wi-Fi switch module" on devices list.
- Confirm on App module indicator light flashing.
- Insert or confirm Wi-Fi network name and password.
- Wait for configuration successfully then tap "Done".
- Rename the device and choose room name if you wish to.

INTEGRATION WITH GOOGLE HOME AND AMAZON ALEXA

Download and install Google Home or Amazon Alexa App for mobile and control your devices with your voice with Smart Speakers or directly with your smartphone.

Important: If you want to link HomCloud App to Google Home or Alexa App you need to select "Smart Life" App between the list of Google Home or Alexa partners. (after that passage the user will be automatically direct to HomCloud App).

NO NEED to download Smart Life App.

Please visit www.homcloud.com/config for support

FAQ

Q1: Which products can I control with the device?
You can control all type of lights, and electrical products in accordance with the device specifications.

Q2: What happens if the wifi goes off?

You can still control the device connected the module with your traditional switch and once Wi-Fi is active again the device connected to module will connect automatically to your Wi-Fi network.

Q3: What should I do if I change the Wi-Fi network or change the password?

You can connect the module to the Wi-Fi network according to the App User Manual.

Q4: How do I reset the device?

Press the traditional switches (connected to the Wi-Fi 1 gang switch module) ON-OFF-ON-OFF for at least 5 times (one time per second) or Power on/off device for 5 times until the indicator light on the module flash quickly.

Please visit www.homcloud.com for more information.

Imported by: Life365 Italy S.p.A. - European General Agency
Viale Roma 49/a, 47122 Forlì, Italy - Made in China



EASY&QUICK CONFIGURATION

APP USER MANUAL



IOS APP / Android APP

1

Scan the QR code to download HOMCLOUD App, or you can also search keyword "HOMCLOUD" at App Store or Googleplay to download App.

2

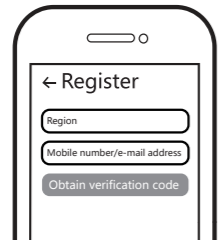

Log in or register your account with your mobile number or e-mail address. Type in the verification code sent to your mobile or mail box, then set your login password. Click "Create Family" to enter into the APP.

3

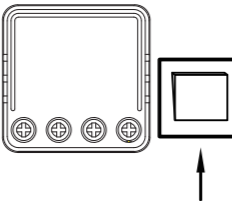

After the wiring of switch module is done, press the traditional switch to turn ON/OFF cycle for 5 times (keep time interval not too short) until the indicator light flash for pairing mode.

4

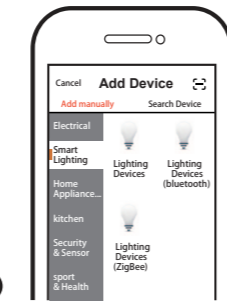

Open the APP, selecting "+" on top right to add device. Choose the type of device, for example "Smart Lighting".

5



Make sure your smart phone and Wi-Fi switch module are under the same Wi-Fi network at 2.4GHz connection. Confirm when the indicator light flash for pairing mode.

6

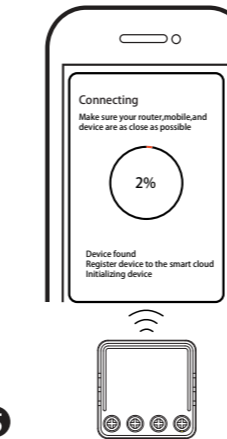

The connecting will take about 10-120 seconds to complete depending on your network condition.

7

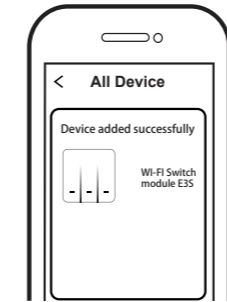

When pairing is done, the Wi-Fi switch will be shown on the App.

8



Connect to amazon alexa or Google Assistant for voice control, or share the devices with your families or friends.

9

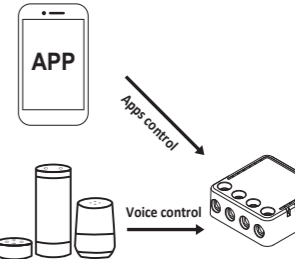

Enjoy your smart life of home automation for lighting control by using our All-in-one mobile app wherever you are in the world or simply by voice control when you are sitting at home comfortably.



WWW.HOMCLOUD.COM
For more info