

Flight 1S

EASY – ORIGINAL – SMART
.....

CAMERA

CE FC 

QUICK GUIDE

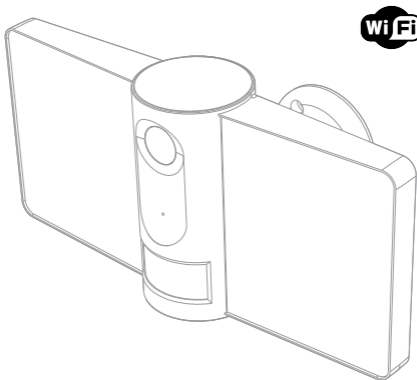

The HomeCloud logo features a house icon above the word 'HOME' in blue, followed by 'CLOUD' in black, and a Wi-Fi signal icon to the right.

What's in the box

Consult the checklist below for all components.



Flight 1S



Bracket



A x 3

B x 3

Bracket screws



Pin



Wire Nuts



User Manual



Screwdriver



Mounting bracket (optional)

Introduction

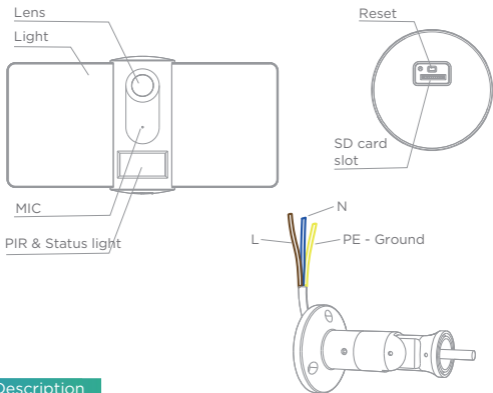

Description

Power AC 100-240V

- Status light
- Red light solids on: the camera network is abnormal
 - Blinking red light: awaiting WiFi connecting
 - Blue light solids on: camera running correctly
 - Blinking blue light: currently connecting

Microphone Captures sounds for your video

SD card slot Supports local SD Card storage (Max.128G)

Reset Press and hold the 'reset' for 5 seconds to reset the device (if you have modified settings, they will return to factory defaults)

Light Turn the light on/off manually or automatically

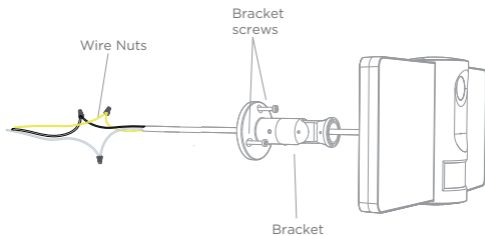

ATTENTION - CAUTION

- 1.AC 100-240V Power connection.
- 2.Disconnect Power before operation. Use your home's circuit breaker to switch off power.This protects you and your camera.

Install

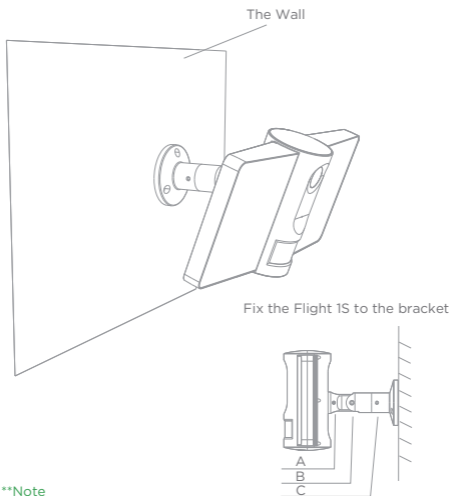

**Note

- A. Fix the camera
- B. Adjust the angle
- C. Adjust the direction and fix the camera.

Connect

Download and Registration

Homcloud is available for both iOS and Android OS

- a. Download Homcloud App from Store or Google Play or scan QR code below.



- b. Enter the register/login interface and register with your country area code and phone number/email address.
- c. Wait a few minutes for verification code (by email or text message) and enter it where required along with a password (between 6 and 20 numbers and letters).

Set up router

This device only supports 2.4GHz frequency band router, does not support 5GHz frequency band router, please set the relevant parameters of the router before WiFi configuration, WiFi passwords do not include special characters such as ~!@#\$%^&*(). When the device is configured in WiFi, the mobile phone and device are as close as to the router, which can speed up the configuration of the device.



QR Code configuration

1. Connect your mobile device to a 2.4GHz Wi-Fi Network and launch Homcloud App.
2. Make sure you have completed all steps of the installation part.
3. On the Homcloud homepage tap "add device" or the icon "+". After that tap "Smart Webcam" on the Wi-Fi smart device list.
4. Hold the camera 15 to 20cm in front of the mobile phone for the camera to scan the QR code. When the camera comes out with a "dong dong dong" sound you can complete the configuration in about 30 seconds.

Scan with the camera

When you tap CONTINUE, the mobile phone displays a QR code. Hold the camera 15 to 20 cm in front of the mobile phone for the camera to scan the QR code.

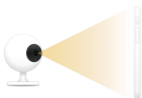

Continue



Heard nothing at all

Heard the beep

5. When connecting, you should make sure your router, mobile, and camera are as close as possible. When camera added successfully, click "Z" you could also DIY the camera's name.

Connecting

Make sure your router, mobile, and device are as close as possible



→ Device found
→ Register device to the smart cloud
→ Initializing device

Device added successfully



Icons



Enlarge the image full screen.



Turn on receiving audio.



Switch to Full HD resolution (SD is Standard Resolution).



Fotografia

Take a snapshot (it will be saved on your smartphone).



Parlare

Activate smartphone microphone and speak through camera.



Registrazione

Record a part of a video (it will be saved on smartphone).



Riproduzione

Play recorded video on SD card.



Cloud Storage

Access cloud recordings (extra service).



Lamp

You can turn on/off lamp manually, with PIR detection or setting a timer.



Buzzer

Use the siren as a deterrent for strangers.

Settings

In "Smart Camera" interface,click 'Z',you can set the camera common functions.

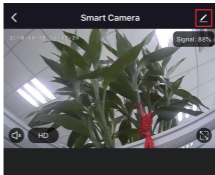
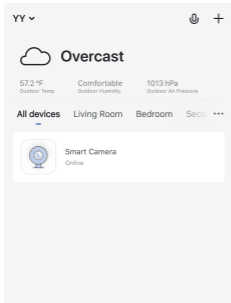

Screenshot



Speak



Record

Specifications and Wi-Fi standard

- Homcloud code: MA-WCF1S
- Model No.: Flight 1S
- Power supply: AC 100 - 240V
- Total power: 32W max
- Working Temp.: -20 C -50 C
- IP rating: IP65 (outdoor)
- Installation: Wall mounting with screws

Camera

- Image sensor: 1/2.9" 2Mega CMOS
- Resolution: 1080p Full HD, 2 Mp 1920(H)*1080(V)
- IR distance: Automatic night visibility up to 10m
- Lens: 2.8mm@F2.0, 135° wide view angle

Video&Audio

- Compression: H.264
- Audio: Bi-directional built-in mic/speaker
- Siren alarm: 120dB

Network

- Communication protocol: TCP/IP,HTTP, DHCP,DNS, RTSP

- Wireless standard: 2.4Ghz WIFI (IEEE802.11b/g/n)
- Channel bandwidth: Support 20/40MHz
- Wifi security: WPA-PSK/WPA2-PSK
- Max transmission power : <13 dbm

Lamp

- Lamp power: 12.5Wx2 lights
- Color temperature: 6000K
- Illumination: 2100 lm max
- Lamp control: Manual/PIR detection/schedule

PIR

- Movement detection range: 12m
- PIR angle: 120°

Storage slot

- Storage: SD card (Max 128Gb), Cloud (extra cost); Botton: Reset

Size

- Dimensions: 260 x 140 x 132 mm
- Net weight: 640g

Functions

Lighting control

You can turn the light on or off with time setting or PIR.

Full-duplex audio

You can see and hear the visitor in your App from the camera.

PIR

When the camera detects someone stopping by, it sends an alarm message to your cell phone.

Record

Using SD card or Opening the Cloud-Storage Service, to keep recording for every moment.

Day & Night

Powerful night vision means no interruptions, even in complete darkness.



Daytime



Night

Google & Alexa Control

If you want to link Homcloud App to Google Home or Amazon Alexa App you need to select "Smart Life" App between the list of Google Home or Alexa partner. (After selecting the Smart Life App, you don't need to register the Smart Life account, ONLY YOU NEED TO LOGIN THE HOMCLOUD ACCOUNT.)

Please visit www.homcloud.com/config for more support.

Note : You will need to have set up a google account prior to linking your Homcloud device.

1. Select "Menu" and then "Home Control".
2. In the "Home Control" screen, select the + icon in the bottom right.
3. A list will appear showing actions and a search functions to access more apps: from here. Choose the Smart Life app.

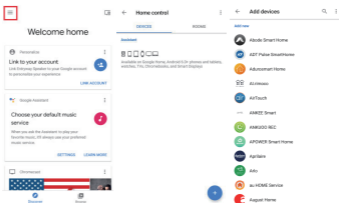

4. Log into your Homcloud account with your email address or mobile number.
5. Click Done, and then it will give you a list of commands available.
6. When successfully linked, you will see it on your "Home Control" screen at the bottom of the app screen. You can control your Homcloud devices through Google Home .

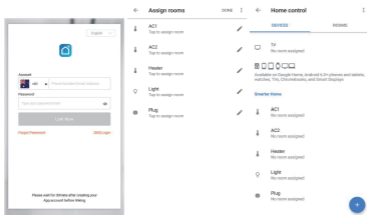

Chromecast Control

1. Tap "Home Control" in the side menu on the Google Home app's home page, then tap "+"

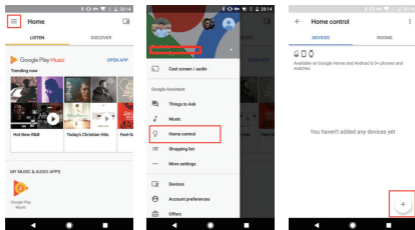

2. Find "Smart Life" in the list. In the new window, select your Homcloud account's region, type your Homcloud account and password, then tap "Link Now". After you assign rooms for devices, your devices will be listed in the Home Control page.

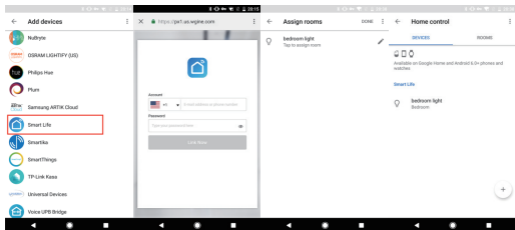

Now, you can display the live image of your smart camera through Google Chromecast.

Note : You will need to have set up an Alexa account prior to linking your Homcloud device.

1. Select "Menu" and then "Skill".
2. Search for the app and enable it.

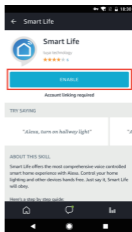
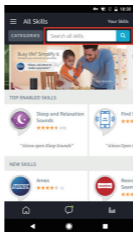
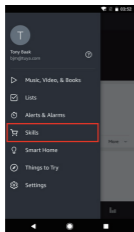

3. Log into your Homcloud account with your email address or mobile number.
4. Select "Discover Device" and the app will begin searching.
5. When successfully linked, you will see a list of connected Homcloud devices. You can now control your Homcloud devices through Alexa with your voice.

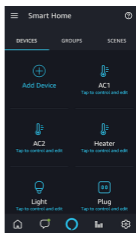
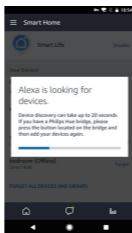
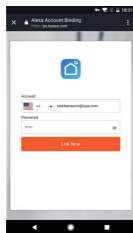

FAQ

Q: In the network process, the process bar is always not 100%, add failure?

A: This camera only supports 2.4GHz WiFi router, please make sure you are using a 2.4GHz WiFi router. And confirm the WiFi password again.

Q: Repeated additions are failures?

A: After adding a failure, it is recommended to restart the device or power off, and then try to add again.

Q: The device cannot be previewed properly?

A: Check whether the network is normal, you can place the camera close to the router, and if not, it is recommended to reset the device and add it again.

Q: How to cut the camera network to another router?

A: First remove and reset the device on the App and then configure the device again by the App.

Q: Why I can't get the notifications with my cell phone App?

A: Please confirm that the App has been running on the phone, and the relevant reminder function has been opened; Message notification and authority confirmation in the mobile phone system have been opened.

Q: Why doesn't the device identify the SD card?

A: It is recommended to plug in SD card after power cut. Confirm whether the SD card is normally available and the format is FAT32. And the TF card can't be identified when the internet environment is not good.

DECLARATION OF CONFORMITY

Hereby, Life365 Italy S.p.A. declares that this wireless device complies with the essential requirements and other provisions correl of Directive 2014/53/EU of the European Parliament and of the Advice. The declaration can be consulted on the website www.homcloud.com/doc.

"Homcloud" is a registered trademark of Life365 Italy S.p.A.

Imported by: Life365 Italy S.p.A. - European General Agency
Viale Roma 49/a, 47122 Forlì, Italy - Made in China

