

# Snap 15S

ORIGINALITY DESIGN SMART - AND BEAUTIFUL

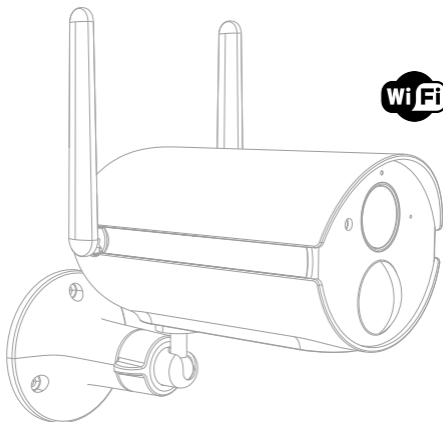

## QUICK GUIDE



HOMECLOUD

# What's in the box

Please consult this checklist for all parts.



Snap 15S



Bracket



Screws



Power adapter



USB cable



User manual

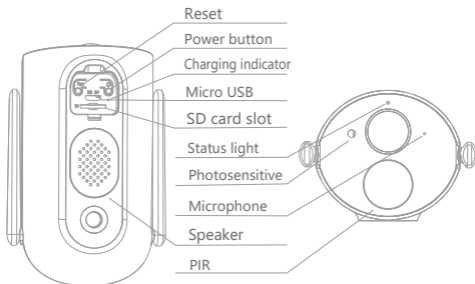

Power port DC 5V±10%

Power on/off Press power button for 3 seconds to turn on/off the camera

Status light

- Solid red light on: the camera is turning on or malfunctional
- Blinking red light: awaiting WiFi connection (slowly blinking)  
connecting the WiFi (quickly blinking)
- Blinking blue light: currently connecting
- Solid blue light on: the camera runs correctly

SD card slot Support local SD card storage (Max.128G)

Reset Press and hold on for 5 seconds to reset the camera

Charging indicator

- Solid red indicator on: battery is charging
- Solid blue indicator on: charging completed

Battery capacity 14400mAh (three 21700 lithium-ion batteries)

## Mode Bracket Installation

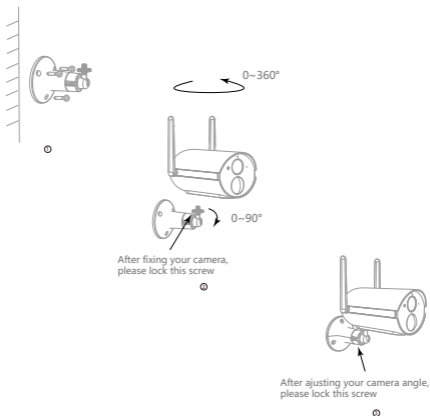

1. Fix the bracket on the wall
2. Install the camera in the bracket and lock it with the screw

## Download and Registration

Homcloud is available for both iOS and Android OS

- a. Download Homcloud App from Store or Google Play or scan QR code below.



- b. Enter the register/login interface and register with your country area code and phone number/email address.
- c. Wait a few minutes for verification code (by email or text message) and enter it where required along with a password (between 6 and 20 numbers and letters).

## Set up router

This device only supports 2.4GHz frequency band router, does not support 5GHz frequency band router, please set the relevant parameters of the router before WiFi configuration, WiFi passwords do not include special characters such as ~!@#\$\$%^&\*(). When the device is configured in WiFi, the mobile phone and device are as close as to the router, which can speed up the configuration of the device.



2.4GHz



5GHz



# QR Code Configuration

1. Connect your mobile device to a 2.4GHz Wi-Fi Network and launch Homcloud App.
2. Make sure you have completed all steps of the installation part.
3. On the Homcloud homepage tap "add device" or the icon "+".  
After that tap "Smart Webcam" on the Wi-Fi smart device list.
4. Hold the camera 15 to 20cm in front of the mobile phone for the camera to scan the QR code. When the camera comes out with a "dong dong dong" sound you can complete the configuration in about 30 seconds.

## Scan with the camera

When you tap CONTINUE, the mobile phone displays a QR code. Hold the camera 15 to 20 cm in front of the mobile phone for the camera to scan the QR code.

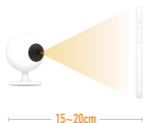

Heard nothing at all

Continue

Heard the beep

5. When connecting, you should make sure your router, mobile, and camera are as close as possible. When camera added successfully, click "✓" you could also DIY the camera's name.

### Connecting

Make sure your router, mobile, and device are as close as possible



- ✓ Device found
- ✓ Register device to the smart cloud
- ✓ Initializing device

### Device added successfully



Completed

## Icons



Enlarge the image full screen.



Turn on receiving audio.



Switch to Full HD resolution (SD is Standard Resolution).



Fotografia

Take a snapshot (it will be saved on your smartphone).



Parlare

Activate smartphone microphone and speak through camera.



Registrazione

Record a part of a video (it will be saved on smartphone).



Riproduzione

Play recorded video on SD card.



Cloud Storage

Access cloud recordings (extra service).

In "Smart Camera" interface,click "",you can set the camera common functions.

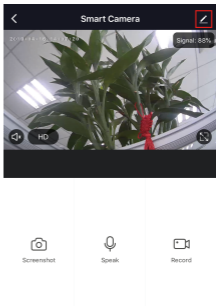
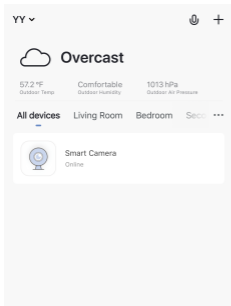

## Specifications

- Homcloud code: ME-WCS15
- Model No: Snap 15S
- Power: DC 5V1A
- Resolution: 2Mp, 1920(H)\*1080(V)
- IR Distance: 10m
- Battery capacity: 14400mA
- Waterproof grade: IP65
- Working temp: -20° C – 50° C
- View Angle: 120°
- Dimension: 156x83x62 mm
- PIR distance: 9m
- Lens: 3.2mm@F2.0, 130°

## Wi-Fi standard

- Wifi standard: 2.4G ~ 2.4835 GHz wifi (IEEE802.11b/g/n)
- Channel bandwidth: Support 20/40MHz
- Wifi security: WPA/WPA2, WPA-PSK/WPA2-PSK, WPS
- Consumption: 150~200mA Max working
- Max transmission power : <20 dbm
- Communication protocol: HTTP,DHCP,DNS,TCP/IP
- Compression: H.264
- Storage: SD CARD(max 128GB), Cloud

# Functions

## Remote wake-up

The camera will be in a sleep mode to save power; you can have a preview in App.

## Full-duplex audio

You can see and hear the visitor in your App from the camera.

## PIR

When the camera detects someone stopping by, it sends an alarm message to your cell phone.

## Low battery alarm

When the battery power is lower than your set, the App will send a notification to your mobile phone.

## Record

Using SD card or opening the Cloud-Storage Service, to keep recording for every moment.

## Day & Night

Powerful night vision means no interruptions, even in complete darkness.



Daytime



Night

## Google Home Control

Note : You will need to have set up an google account prior to linking your Homcloud device.

1. Select "Menu" and then "Home Control".
2. In the "Home Control" screen, select the + icon in the bottom right.
3. A list will appear showing actions and a search funtions to access more apps: from here. Choose the Smart Life app.

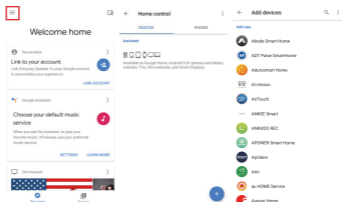

4. Log into your Homcloud account with your email address or mobile number.
5. Click Done, and then it will give you a list of commands available.
6. When successfully linked, you will see it on your "Home Control" screen at the bottom of the app screen. You can control your Homcloud devices through Google Home .

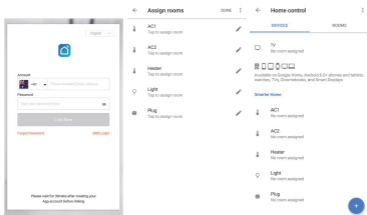

## Chromecast Control

1. Tap "Home Control" in the side menu on the Google Home app's home page, then tap "+"

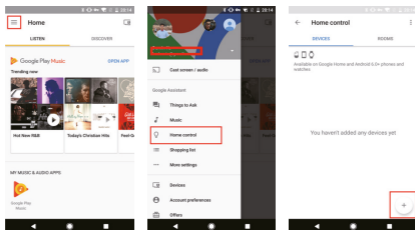

2. Find "Smart Life" in the list. In the new window, select your Homcloud account's region, type your Homcloud account and password, then tap "Link Now". After you assign rooms for devices, your devices will be listed in the Home Control page.

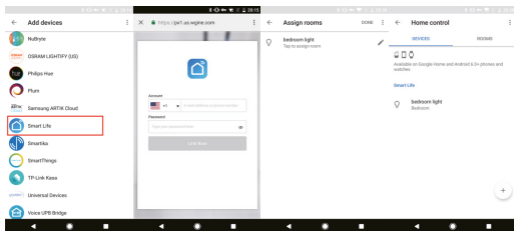

Now, you can display the live image of your smart camera through Google Chromecast.

## Alexa Control

Note : You will need to have set up an Alexa account prior to linking your Homcloud device.

1. Select "Menu" and then "Skill".
2. Search for the app and enable it.

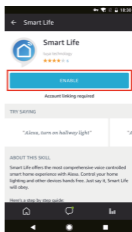
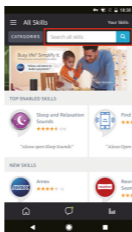
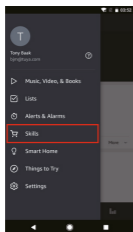

3. Log into your Homcloud account with your email address or mobile number.
4. Select "Discover Device" and the app will begin searching.
5. When successfully linked, you will see a list of connected Homcloud devices. You can now control your Homcloud devices through Alexa with your voice.

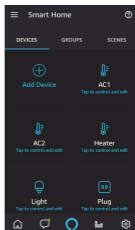
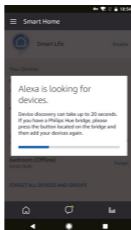
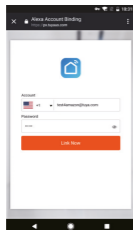

Q: The device cannot be previewed properly?

A: Check whether the network is normal, you can place the camera close to the router, and if not, it is recommended to reset the device and add it again.

Q: Why is it still in the list of devices after resetting?

A: The reset device only resets the network configuration of the camera, but cannot change the configuration on the App, remove the camera, and must be deleted by the App.

Q: How to cut the camera network to another router?

A: First remove and reset the device on the App and then configure the device again by the App.

Q: Why doesn't the device identify the SD card?

A: It is recommended to plug in SD card after power cut. Confirm whether the SD card is normally available and the format is FAT32. And the TF card can't be identified when the internet environment is not good.

Q: Why I can't get the notifications with my cell phone App?

A: Please confirm that the App has been running on the phone, and the relevant reminder function has been opened; Message notification and authority confirmation in the mobile phone system have been opened.

### DECLARATION OF CONFORMITY

Hereby, Life365 Italy S.p.A. declares that this wireless device complies with the essential requirements and other provisions correl of Directive 2014/53 / EU of the European Parliament and of the Advice. The declaration can be consulted on the website [www.homcloud.com/doc](http://www.homcloud.com/doc).

"Homcloud" is a registered trademark of Life365 Italy S.p.A.

Imported by: Life365 Italy S.p.A. – European General Agency  
Viale Roma 49/a, 47122 Forlì, Italy – Made in China

