

Speed 16S

ORIGINALITY DESIGN SMART - AND BEAUTIFUL



CAMERA



QUICK GUIDE

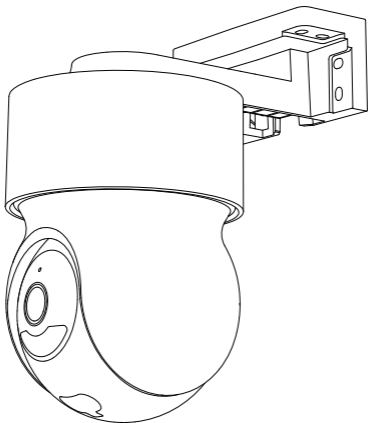

 **HOME**CLOUD 

What's in the box

Please consult this checklist for all parts.

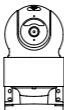

Camera



Power adapter



Screw package

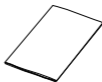

Manual

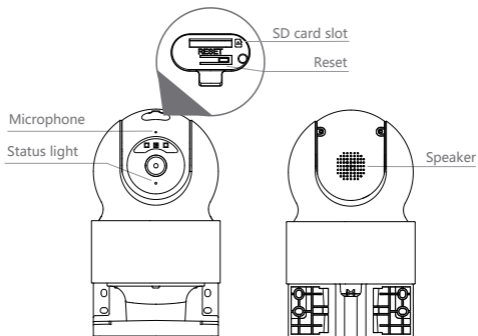

Power DC12V/1A

- Status light
- Blinking red light: connecting the network (fast)
 - Solid blue light on: camera is working correctly
 - Solid red light on: camera is malfunctional

Microphone Capture sound for your video

SD card slot Support local SD Card storage (Max.128 GB)

Reset Press and hold for 5 seconds to reset the camera (if you have modified settings, they will return to factory defaults)

1 Wall mount

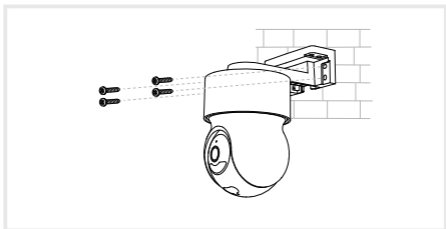

2 Ceiling mount

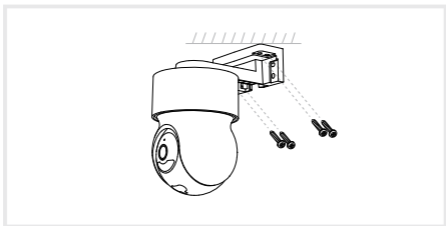

Download and Registration

Homcloud is available for both iOS and Android OS

- a. Download Homcloud App from Store or Google Play or scan QR code below.



- b. Enter the register/login interface and register with your country area code and phone number/email address.
- c. Wait a few minutes for verification code (by email or text message) and enter it where required along with a password (between 6 and 20 numbers and letters).

Set up router

This device only supports 2.4GHz frequency band router, does not support 5GHz frequency band router, please set the relevant parameters of the router before WiFi configuration, WiFi passwords do not include special characters such as ~!@#\$\$%*&*(). When the device is configured in WiFi, the mobile phone and device are as close as to the router, which can speed up the configuration of the device.



1. Connect your mobile device to a 2.4GHz Wi-Fi Network and launch Homcloud App.
2. Make sure you have completed all steps of the installation part.
3. On the Homcloud homepage tap "add device" or the icon "+". After that tap "Smart Webcam" on the Wi-Fi smart device list.
4. Hold the camera 15 to 20cm in front of the mobile phone for the camera to scan the QR code. When the camera comes out with a "dong dong dong" sound you can complete the configuration in about 30 seconds.

Scan with the camera

When you tap CONTINUE, the mobile phone displays a QR code. Hold the camera 15 to 20 cm in front of the mobile phone for the camera to scan the QR code.

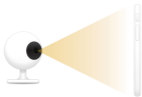

15~20cm

Continue



Heard nothing at all

Heard the beep

5. When connecting, you should make sure your router, mobile, and camera are as close as possible. When camera added successfully, click "↗" you could also DIY the camera's name.

Connecting

Make sure your router, mobile, and device are as close as possible



- ✓ Device found
- ✓ Register device to the smart cloud
- ✓ Installing device

Device added successfully



Completed

Icons



Enlarge the image full screen.



Turn on receiving audio.



Switch to Full HD resolution (SD is Standard Resolution).



Fotografia

Take a snapshot (it will be saved on your smartphone).



Parlare

Activate smartphone microphone and speak through camera.



Registrazione

Record a part of a video (it will be saved on smartphone).



Riproduzione

Play recorded video on SD card.



Cloud Storage

Access cloud recordings (extra service).

In "Smart Camera" interface,click ",you can set the camera common functions.

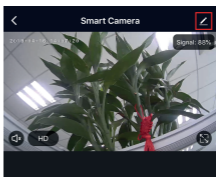
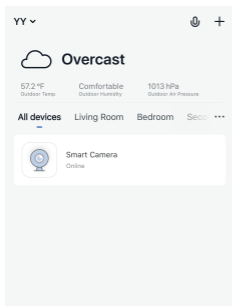

Screenshot



Speak



Record

Specifications

- Homcloud code: ME-WCS16SPT
- Model No: Speed 16S
- Power: DC 12V1A (included)
- Resolution: 2Mp, 1920(H)*1080(V)
- IR Distance: 10m
- Pan: 0° a 350° , Tilt: -90° a 30°
- Waterproof grade: IP65
- Working temp: -20° C - 50° C
- View Angle: 130°
- Dimension: 148x103x108 mm
- PIR distance: 9m
- Lens: 3.0mm@F2.0, 130°

Wi-Fi standard

- Wifi standard: 2.4G ~ 2.4835 GHz wifi (IEEE802.11b/g/n)
- Channel bandwidth: Support 20/40MHz
- Wifi security: 64/128-bit, WPA/WPA2, WPA-PSK/WPA2-PSK, WPS
- Consumption: 150-200mA Max working
- Max transmission power : <20 dbm
- Communication protocol: HTTP,DHCP,DNS,TCP/IP, RTSP
- Compression: H.264
- Storage: SD CARD(max 128GB), Cloud, NVR

Pan/Tilt

Rotate your camera by sliding on your smartphone, providing you with a good vision.

Video flip

Flip your video stream up or down for maximum flexibility.

Full color vision

With white light, the captured pictures and videos of motion detection are colorful which can provide you a better vision.

Motion detection

Support smart motion detection. The camera will detect movements, and then send you push notifications and app alerts.

Record

Support 24H continuous recording with high capacity SD storage or Cloud storage.

Day & Night

Never miss a moment, even in complete darkness, with powerful night-vision technology.



Daytime



Night

Google Home Control

Note : You will need to have set up a google account prior to linking your Homcloud device.

1. Select "Menu" and then "Home Control".
2. In the "Home Control" screen, select the + icon in the bottom right.
3. A list will appear showing actions and a search functions to access more apps: from here. Choose the Smart Life app.

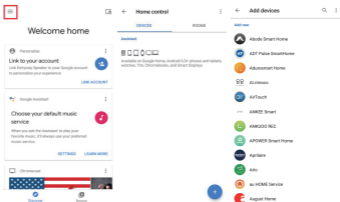

4. Log into your Homcloud account with your email address or mobile number.
5. Click Done, and then it will give you a list of commands available.
6. When successfully linked, you will see it on your "Home Control" screen at the bottom of the app screen. You can control your Homcloud devices through Google Home .

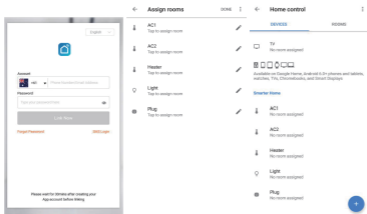

Chromecast Control

1. Tap "Home Control" in the side menu on the Google Home app's home page, then tap "+"

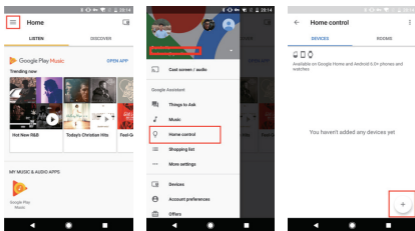

2. Find "Smart Life" in the list. In the new window, select your Homcloud account's region, type your Homcloud account and password, then tap "Link Now". After you assign rooms for devices, your devices will be listed in the Home Control page.

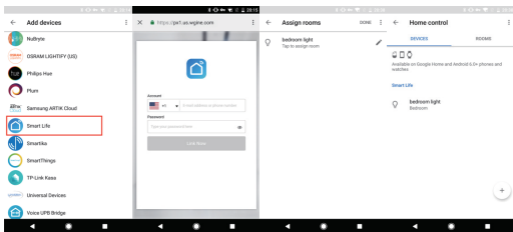

Now, you can display the live image of your smart camera through Google Chromecast.

Alexa Control

Note : You will need to have set up an Alexa account prior to linking your Homcloud device.

1. Select "Menu" and then "Skill".
2. Search for the app and enable it.

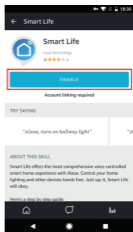
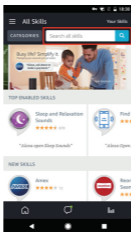
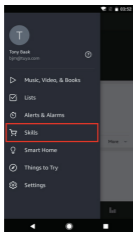

3. Log into your Homcloud account with your email address or mobile number.
4. Select "Discover Device" and the app will begin searching.
5. When successfully linked, you will see a list of connected Homcloud devices. You can now control your Homcloud devices through Alexa with your voice.

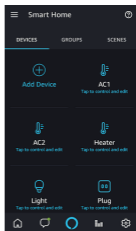
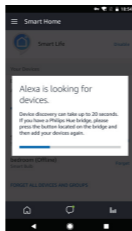
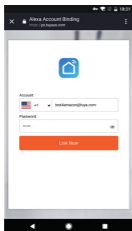

Q: The device cannot be previewed properly?

A: Check whether the network is normal, you can place the camera close to the router, and if not, it is recommended to reset the device and add it again.

Q: Why is it still in the list of devices after resetting?

A: The reset device only resets the network configuration of the camera, but cannot change the configuration on the App, remove the camera, and must be deleted by the App.

Q: How to cut the camera network to another router?

A: First remove and reset the device on the App and then configure the device again by the App.

Q: Why doesn't the device identify the SD card?

A: It is recommended to plug in SD card after power cut. Confirm whether the SD card is normally available and the format is FAT32. And the TF card can't be identified when the Internet environment is not good.

Q: Why I can't get the notifications with my cell phone App?

A: Please confirm that the App has been running on the phone, and the relevant reminder function has been opened; Message notification and authority confirmation in the mobile phone system have been opened.

DECLARATION OF CONFORMITY

Hereby, Life365 Italy S.p.A. declares that this wireless device complies with the essential requirements and other provisions corrol of Directive 2014/53 / EU of the European Parliament and of the Advice. The declaration can be consulted on the website www.homcloud.com/doc.

"Homcloud" is a registered trademark of Life365 Italy S.p.A.

Imported by: Life365 Italy S.p.A. – European General Agency
Viale Roma 49/a, 47122 Forli, Italy – Made in China

